

As of: 10/17/2023

**Property Owner****Name:** HAUGEN RUSSELL C & AMPARO  
HAUGEN RUSSELL C**Mailing Address:** PO BOX 195  
ALTUS, AR 72821**Type:** (RI) Res. Improv.**Tax Dist:** (14) OZARK/ALTUS RURAL**Millage Rate:** 47.90**Extended Legal:** 34 PHASE 1 LOT 34 215-573**Property Information****Physical Address:** 7424 HAGGERTY LN**Subdivision:** DARDANELLE CORP SUBDIVISION  
PH**Block / Lot:** N/A / N/A**S-T-R:** 34-09-26**Size (Acres):** 3.430**Market and Assessed Values**

	Estimated Market Value	Full Assessed (20% Mkt Value)	Taxable Value
<b>Land:</b>	\$15,300	\$3,060	\$1,600
<b>Building:</b>	160550	32110	21285
<b>Total:</b>	\$175,850	\$35,170	\$22,885

**Taxes**

<b>Estimated Taxes:</b>	\$671	
<b>Homestead Credit:</b>	\$425	Note: Tax amounts are estimates only. Contact the county/parish tax collector for exact amounts.
<b>Status:</b>	(F) - Fixed	

**Land**

Land Use	Size	Units
	1.000	Lot
	2.430	Acres
<b>Total</b>	<b>3.430</b>	

**Deed Transfers**

Deed Date	Book	Page	Deed Type	Stamps	Est. Sale	Grantee	Code	Type
1/16/2003	215	573	Warr. Deed			HAUGEN	Valid	N/A
9/11/2000	209	324	N/A	92.40	\$28,000	MCREYNOLD S	Valid	N/A
12/12/1996	193	404	Warr. Deed	82.50	\$25,000	DARDANELLE CORP	Valid	N/A

**Reappraisal Value History**

Tax Year	Total Value	Total Assessed
2015	\$150,000.00	\$22,885.00
2016	\$154,500.00	\$22,885.00
2017	\$154,500.00	\$22,885.00
2018	\$154,500.00	\$22,885.00
2019	\$154,500.00	\$22,885.00
2020	\$154,500.00	\$22,885.00
2021	\$175,850.00	\$22,885.00
2022	\$175,850.00	\$22,885.00

**Details for Residential Card 1**

As of: 10/17/2023

Occupancy	Story	Construction	Total Liv	Grade	Year Built	Age	Condition	Beds
Single Family	ONE	Masonry Veneer	2,414	3	2005	16	Average	

**Exterior Wall:** MASON VEN

**Foundation:** Closed Piers

**Floor Struct:** Wood with subfloor

**Floor Cover:** Carpet & Tile

**Insulation:** Ceilings Walls

**Roof Cover:** Metal

**Roof Type:** Gable

**Plumbing:** Full: 2

**Fireplace:** N/A

**Heat / Cool:** Central

**Basement:** N/A

**Basement Area:**

**Year Remodeled:**

**Style:**



DataScout, LLC

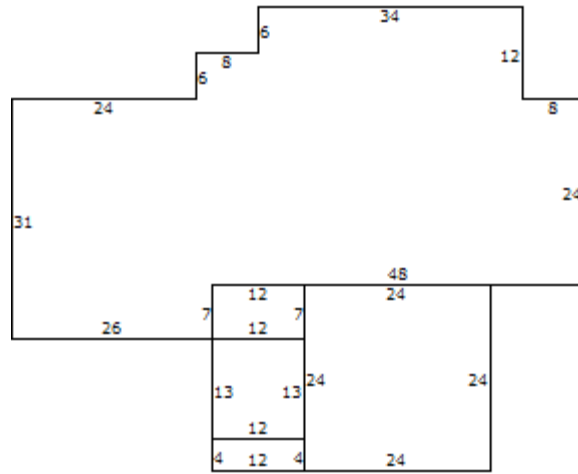

**Base Structure**

Item	Label	Description	Area
A	DWG	Dwelling	2414
B	MUA	Garage - masonry unfinished, attached	576
C	OP	Porch, open	84
D	OP2	Porch, half open	156
E	PS	Patio slab	48

**Outbuildings and Yard Improvements**

Item	Type	Size/Dim	Unit Multi.	Quality	Age
Utility Bldg, Avg, Exc Class		40x40			2010
Driveway, concrete		10x40			2010

**Other Adjustments**

Code	Type	Quantity
FLOORC	H	1111

Map

---

